

PRODUCT SPECIFICATION
BR040

Version:20191009v1

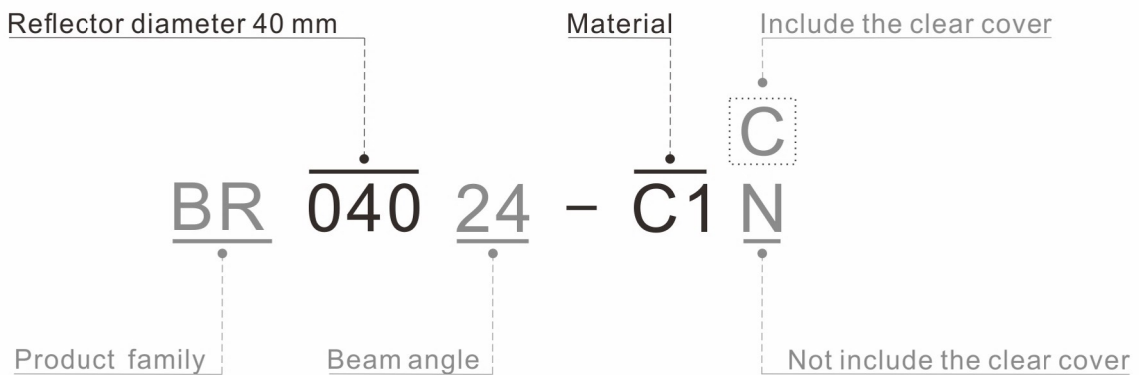

Basic parameters	-----	P2
Photometric data	-----	P3
Product dimension	-----	P4
Packing information	-----	P5

PRODUCT EXPLAIN

BASIC PARAMETERS

Model	BR040
Beam angle	24°/38°/58°
Cover	Clear / Foggy
Operating temperature (Tj)	≤85°C
Plating/Color	Vacuum plating/Silver
RoHS	Yes
Material	PC
Lens	No

SOURCE

Bridgelux: E6 / E8 / V10 Gen8 / V8 Gen7 / V6 Gen6 / V8 Gen6 / V4 HD / Vero 10 Gen6 / Vero 10 Gen7

Cree: CXA1304 / CXB1304 / CXB1310 / CMA1306

Citizen: CLU7A2 / CLU7B2 / CLU701 / CLU702

HOLDERS



BRHV068-F



BRHV068-PA



BRHV068-PD

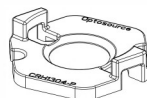

CRH1304-P

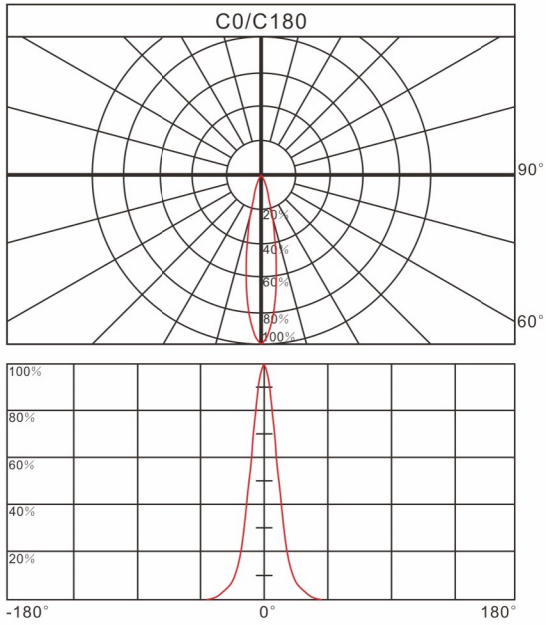
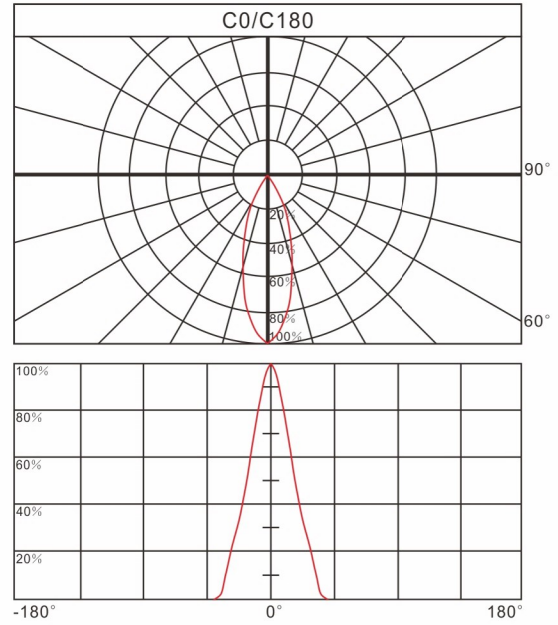
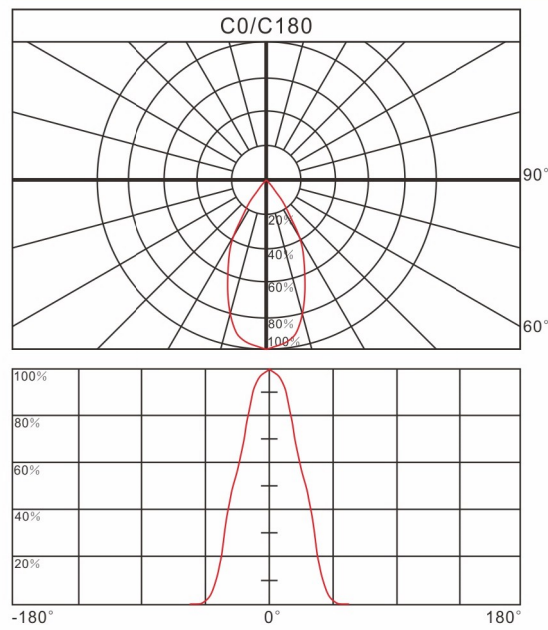

H121414E-01

PHOTOMETRIC DATA
Relative intensity of BR04024

Relative intensity of BR04038

Relative intensity of BR04058

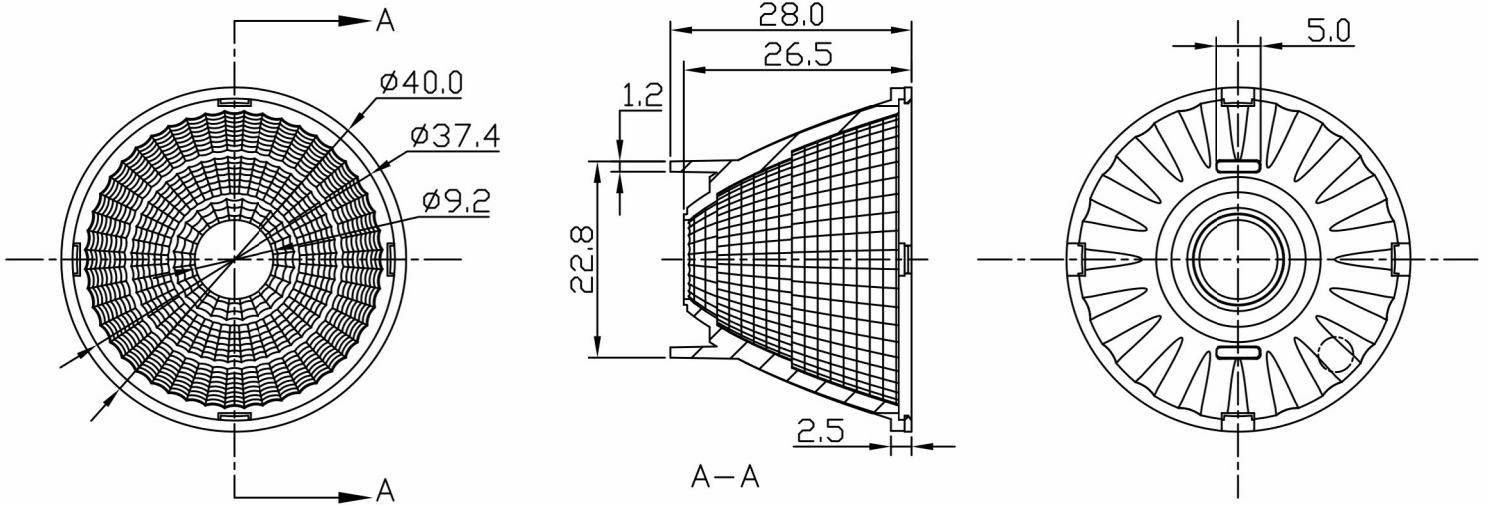
PRODUCT DIMENSION

Unit:mm



PACKING INFORMATION

Packing quantity	400pcs/8 layers / carton
Gross weight	3.1kgs
Carton measurement	515*290*270mm

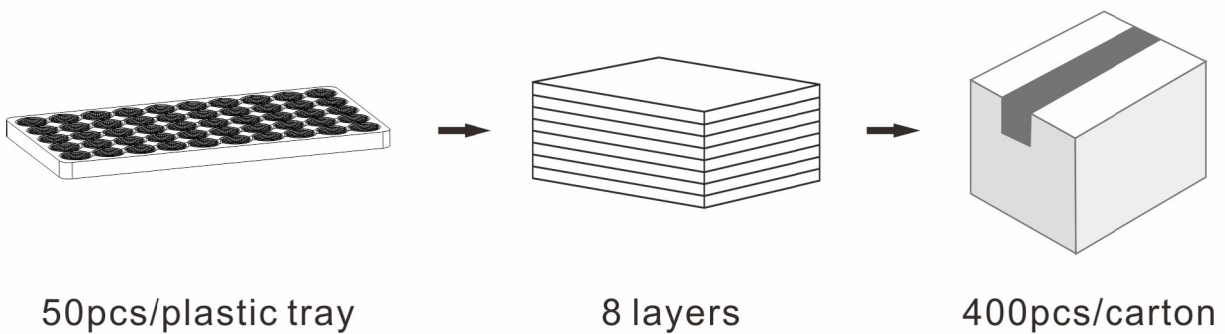

Note:

* Above measurement and weight are measured manually.
 If there have any difference, please refer to the actual product.

2/F, Building C1, No.73 Weiwu Road, Zengcheng, Guangzhou, China



Tel: +86 20 8266 0966
 Fax: +86 20 8264 3119

E-mail: sales@opto-source.com
 Website: www.opto-source.com