

PRODUCT SPECIFICATION
BR040-C1N

Version:20191009v1



Basic parameters	-----	P2
Photometric data	-----	P3
Product dimension	-----	P4
Packing information	-----	P5

PRODUCT EXPLAIN

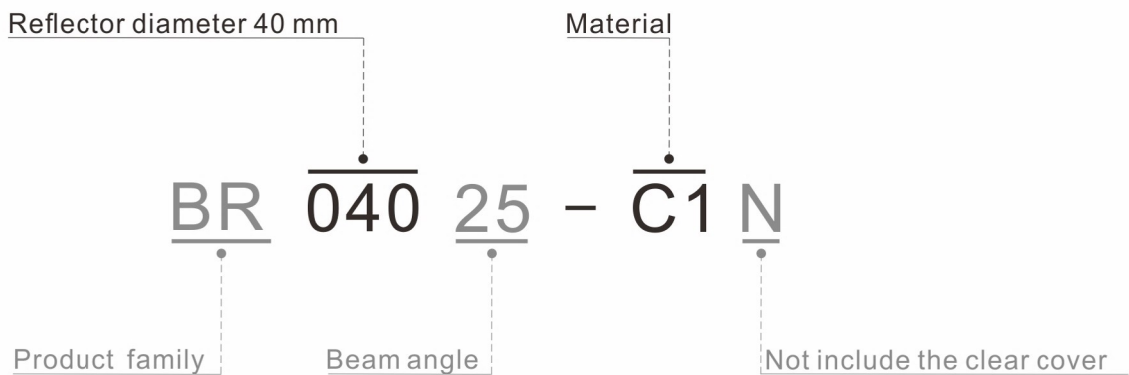

BASIC PARAMETERS

Model	BR040-C1N
Beam angle	25°/40°/60°
Cover	No
Operating temperature (Tj)	≤85°C
Plating/Color	Vacuum plating/Silver
RoHS	Yes
Material	PC
Lens	(25°/Yes) (40°60°/No)

SOURCE

Bridgelux: E6 / E8 / E10 / V8 Gen8 / V10 Gen8 / V10 Gen7 / V6 Gen6 / V8 Gen6 / V10 Gen6
V6 HD / Vero 10 Gen6 / Vero 10 Gen7

Cree: CXA15xx / CXB15xx / CMA1516 / CMT14xx

Citizen: CLU7A2 / CLU7B2 / CLU701 / CLU702

Lumileds: 1202s / 1202HD

Luminus: CHM-9(AC00) Gen1 / CLM-9(AC00) Gen1 / CXM-9(AC00) Gen1 / CHM-6-XH20 Gen2
CHM-9(AC10) Gen2 / CXM-9(AC00) Gen2 / CIM-9(AC30) Gen3 / CLM-9(AC30) Gen3
CXM-9(AC30) Gen3 / CIM-9 Gen4 / CLM-9(AC40) Gen4 / CXM-9 Gen4

Nichia: NTCWT012B / NTCWS024B / NVNWS007Z / NJCWS024Z

Osram: S9

Seoul: SAWS0661A / SAWS1063A / SAW00661A / SAW01062A / SAW01063A / SAW80661A
SAW90661A / SAW81062A SAW91062A / SAW81063A SAW91063A

Samsung: LC010C / LC003D / LC006D / LC009D / LC013D

Tridonic: SLE G7 9mm

HOLDERS



BCH1020-A



BRHV008-PB



BRHV010-C

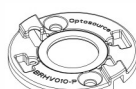

BRHV010-P



BRHV068-F



BRHV068-PD



CIHL020-A



CIHL020-P



CRH1507-P



H121414E-01



H11512D-01



NIHN036-P

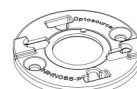

NIHN066-P



PIH1203-P

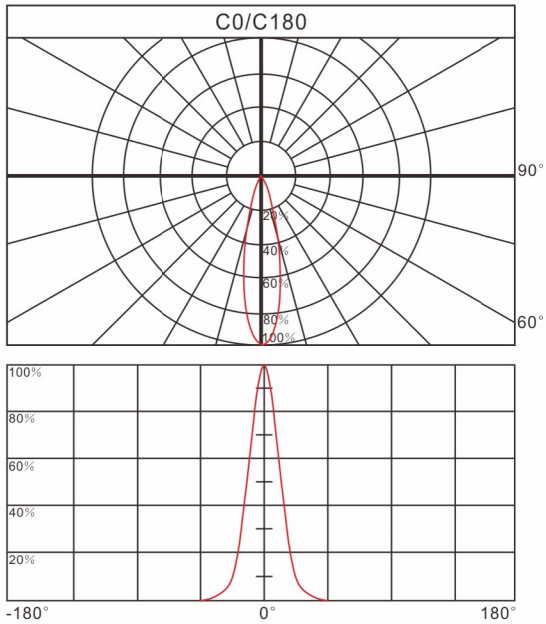
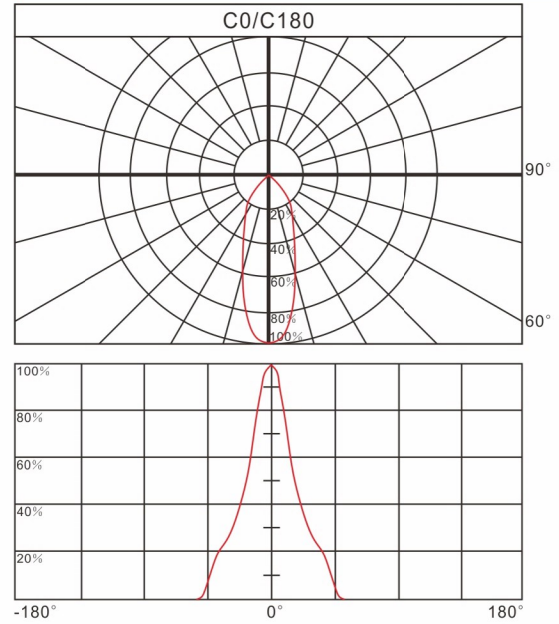
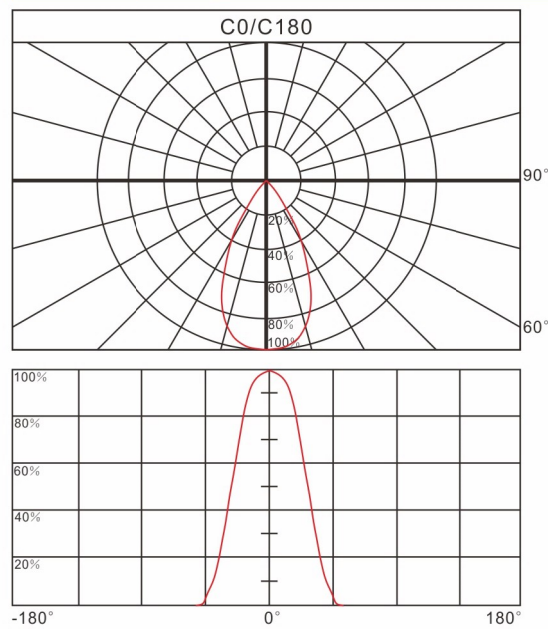

SHHMINI-P

PHOTOMETRIC DATA
Relative intensity of BR04025

Relative intensity of BR04040

Relative intensity of BR04060

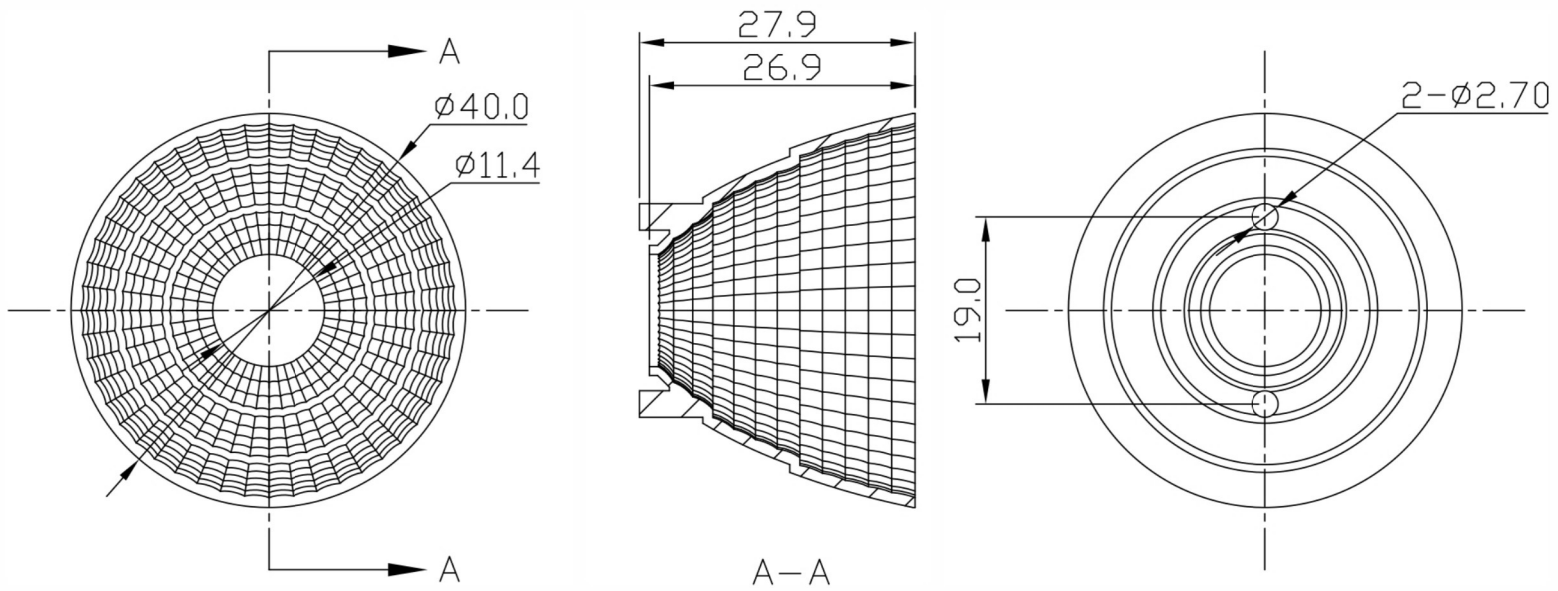
PRODUCT DIMENSION

Unit:mm



PACKING INFORMATION

Packing quantity	400pcs/8 layers / carton
Gross weight	2.9kgs
Carton measurement	515*290*270mm

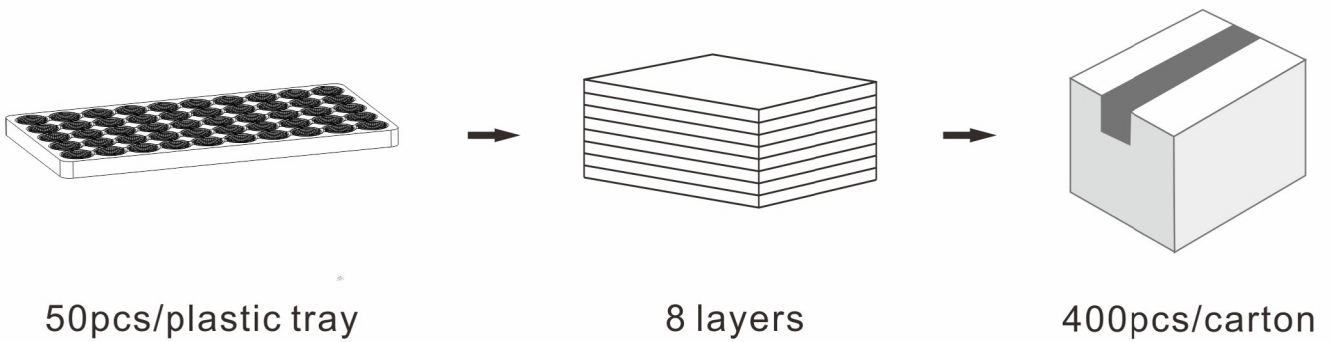

Note:

* Above measurement and weight are measured manually.
If there have any difference, please refer to the actual product.

2/F, Building C1, No.73 Weiwu Road, Zengcheng, Guangzhou, China



Tel: +86 20 8266 0966
Fax: +86 20 8264 3119

E-mail: sales@opto-source.com
Website: www.opto-source.com