

PRODUCT SPECIFICATION
CR033

Version:20191009v1

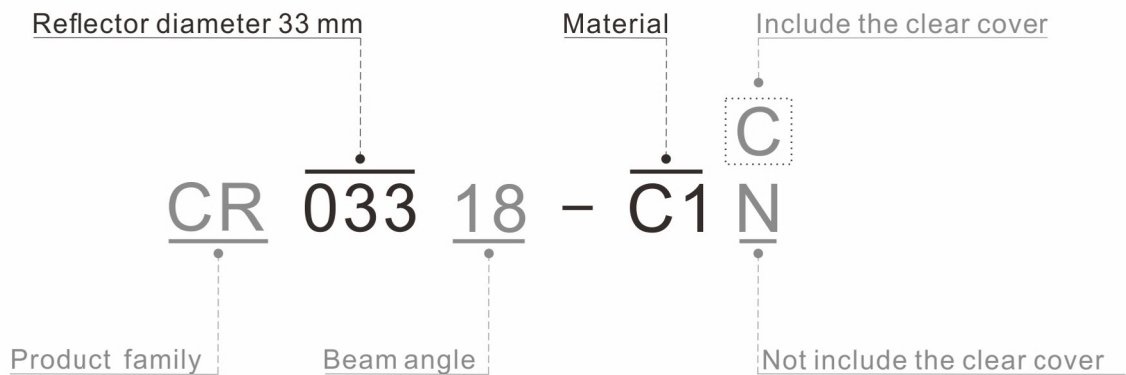

Basic parameters	-----	P2
Photometric data	-----	P3
Product dimension	-----	P4
Packing information	-----	P5

PRODUCT EXPLAIN

BASIC PARAMETERS

Model	CR033
Beam angle	18°/40°/60°
Cover	Clear / Foggy
Operating temperature (Tj)	≤85°C
Plating/Color	Vacuum plating/Silver
RoHS	Yes
Material	PC
Lens	No

SOURCE

Bridgelux: E6 / E8 / V8 Gen8 / V8 Gen7 / V6 Gen6 / V8 Gen6 / V4 HD

Citizen: CLU7A2 / CLU7B2 / CLU701 / CLU702

Cree: CXA1304 / CXB1304 / CXB1310 / CMA1306

HOLDERS



BRHV068-F



BRHV068-PA



BRHV068-PD

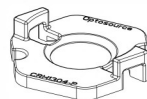

CRH1304-P

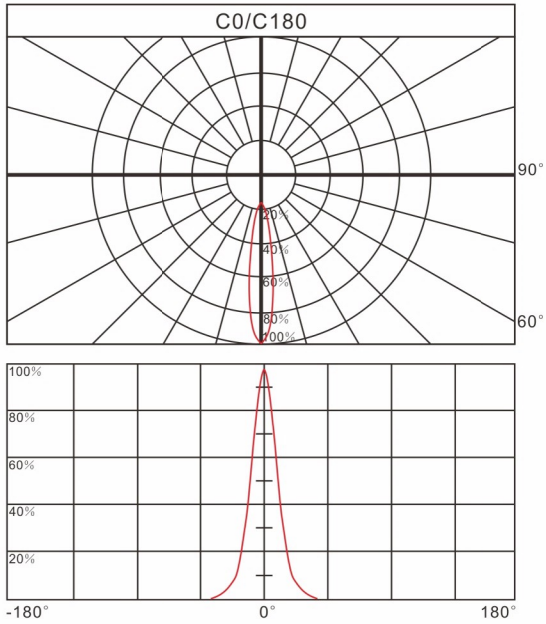
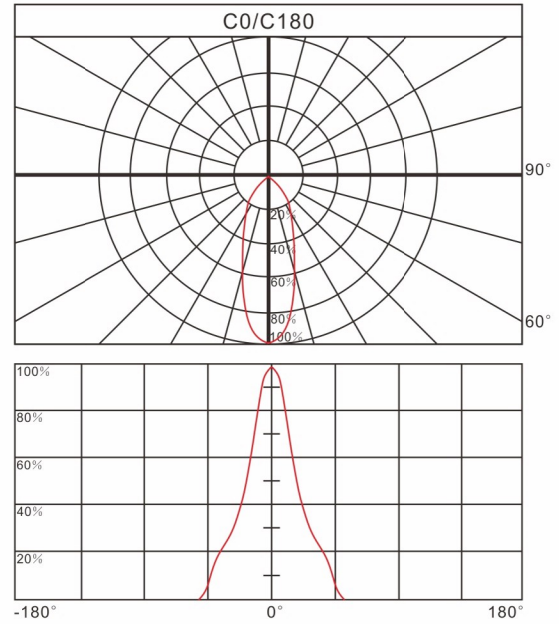
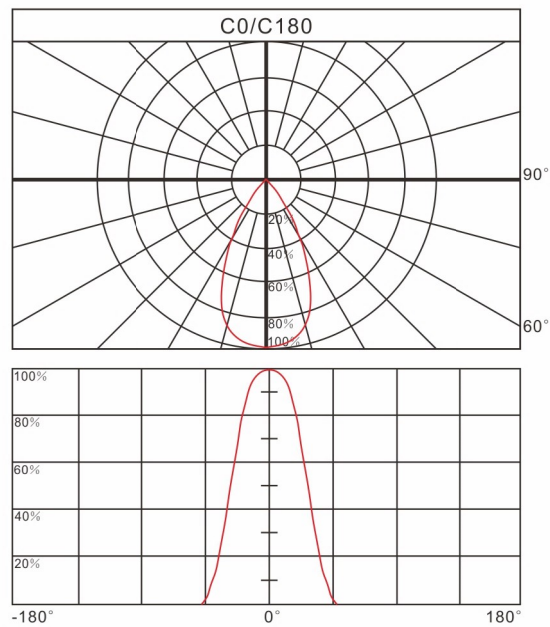

H121414E-01

PHOTOMETRIC DATA
Relative intensity of CR03318

Relative intensity of CR03340

Relative intensity of CR03360

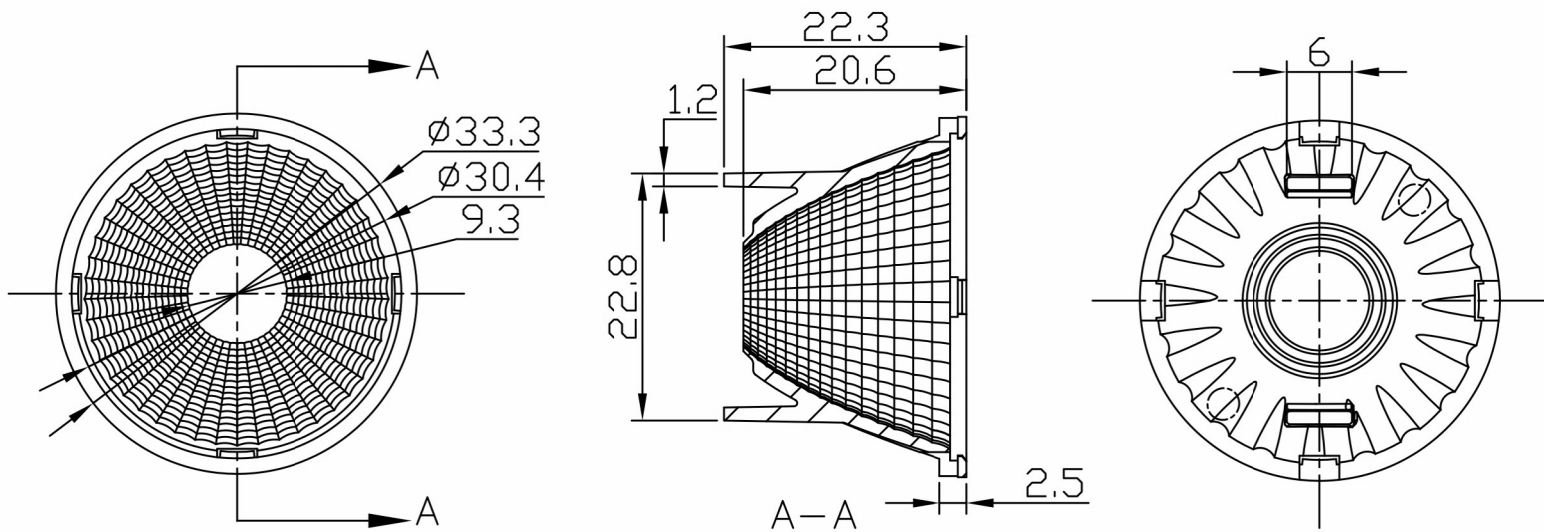
PRODUCT DIMENSION

Unit:mm



PACKING INFORMATION

Packing quantity	500pcs/10 layers / carton
Gross weight	2.8kgs
Carton measurement	515*290*270mm

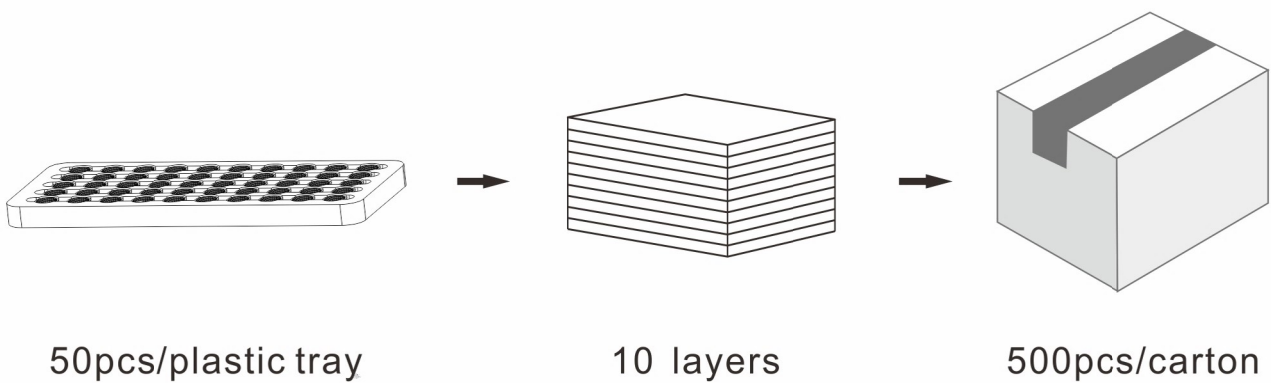

Note:

- * Above measurement and weight are measured manually.
If there have any difference, please refer to the actual product.

2/F, Building C1, No.73 Weiwu Road, Zengcheng, Guangzhou, China



Tel: +86 20 8266 0966
Fax: +86 20 8264 3119

E-mail: sales@opto-source.com
Website: www.opto-source.com